

# Winter Table Runner

*The center star blocks are emphasized by the subtle stars in the sashings. A triangle added to each end of a sashing strip creates the sashing stars.*



Table Runner designed and made by Jean Ann Wright.

## Materials

Finished size approximately 20" x 40"

Star blocks: 8" x 8"

wof indicates width of fabric

**Note:** Sew all blocks with a scant 1/4" seam and press all seams as you sew.

- Fabric A—1/3 yard holly print (borders)
- Fabric B—1/4 yard tree border print (borders)
- Fabric C—1/2 yard red print (sashings)
- Fabric D—1/2 yard gold print (Star blocks, sashings)
- Fabric E—1/3 yard lime green (Star blocks, sashing squares)
- Fabric F—1/4 yard white mini-print (Star blocks)
- Fabric G—1/3 yard allover tree print (binding)
- Backing—1-1/2 yards
- Thread for machine quilting
- Craft size batting

**Note:** Sulky® 40 wt Rayon #1051 Christmas green thread and Quilter's Dream® Green batting were used in this project.

## Cutting Instructions

### Fabric A, cut:

- (1) 8-1/2" x wof strip, from this strip cut:
  - (6) 4-1/2" x 8-1/2" side border pieces.

### Fabric B, fussy cut:

- (1) 6-1/2" x wof strip, from this strip cut:
  - (2) 8-1/2" x 6-1/2" top/bottom border pieces.
  - (4) 4-1/2" x 6-1/2" top/bottom border pieces.

### Fabric C, cut:

- (5) 2-1/2" x wof strips, from these strips cut:
  - (10) 2-1/2" x 8-1/2" sashing strips,
  - (8) 2-1/2" x 4-1/2" sashing strips and
  - (4) 2-1/2" x 6-1/2" sashing strips.

### Fabric D, cut:

- (2) 2-1/2" x wof strips, from these strips cut:
  - (32) 2-1/2" squares.
- (1) 4-1/2" x wof strip, from this strip cut:
  - (3) 4-1/2" squares.

### Fabric E, cut:

- (2) 2-1/2" x wof strips, from these strips cut:
  - (20) 2-1/2" squares.

Cut (2) 2-1/2" x wof strips, from these strips cut:

- (12) 2-1/2" x 4-1/2" rectangles.

**Fabric F, cut:**

- (2) 2-1/2" x wof strips, from these strips cut:  
(24) 2-1/2" squares.

**Fabric G, cut:**

- (4) 2-1/4" x wof strips, sew together end-to-end for binding.

**Star Block Assembly**

- 1. Lay a fabric F 2-1/2" square on one side of a fabric E 2-1/2" x 4-1/2" rectangle, right sides together. Sew a diagonal line across the 2-1/2" square and through the fabric layers.



- 2. Trim 1/4" away from the sewn line and press the seam allowance toward the triangle.



- 3. Lay a fabric F 2-1/2" square on the opposite side of the fabric E 2-1/2" x 4-1/2" rectangle. Sew, trim and press as before to complete a Flying Geese unit. Make (12) Flying Geese units.

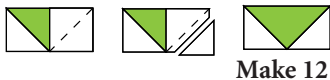

- 4. Sew a Flying Geese unit to opposite sides of a fabric D 4-1/2" square to make a block center. Make (3) block centers.

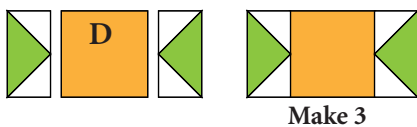

- 5. Sew a fabric E 2-1/2" square to opposite sides of the remaining Flying Geese units.

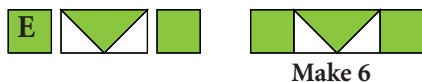

- 6. Lay out (2) Flying Geese units and a block center. Sew the units together to make a Star block. Make (3) Star blocks.

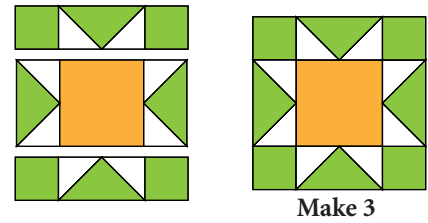

**Sashing Assembly**

- 1. Lay a fabric D 2-1/2" square on each end of a Fabric C 2-1/2" x 8-1/2" sashing strip, right sides together. Sew in a diagonal line across the 2-1/2" square and through the fabric layers as shown. Make sure both seams are going in the same direction.



- 2. Trim 1/4" away from the sewn line and press seams toward the triangles to make a long C/D sashing strip. Make (10) long C/D sashing strips.



- 3. Lay a fabric D 2-1/2" square on the right end of a fabric C 2-1/2" x 4-1/2" sashing strip, right sides together. Sew a diagonal line in the same direction as the long C/D sashing strips. Make (8) short C/D sashing strips. Repeat with the fabric C 2-1/2" x 6-1/2" sashing strips and the fabric D 2-1/2" squares to make (4) medium C/D sashing strips.



**Sashing Row Assembly**

- Lay out (2) short C/D sashing strips, (2) fabric E 2-1/2" squares and (1) long C/D sashing strip, as shown. Check the orientation of the triangle star points. Sew the pieces together to complete a sashing row. Make (4) sashing rows.

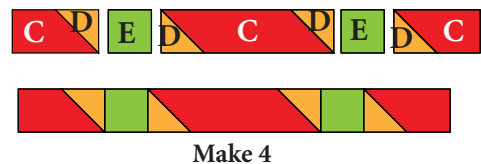

## Table Runner Assembly

1. Sew a long C/D sashing strip to each side of a Star block. Make 3.

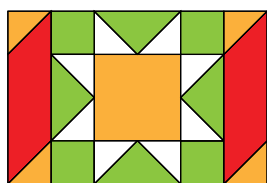

Make 3

2. Sew a fabric A 4-1/2" x 8-1/2" side border piece to the units made in step 1. Make 3.

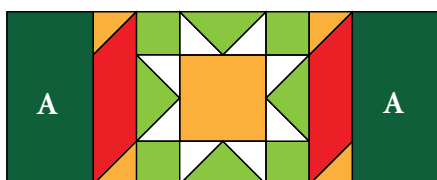

Make 3

3. Referring to the Table Runner Assembly Diagram, lay out (4) sashing rows and (3) block rows. Sew the rows together to complete the table runner center.
4. Lay out (2) fabric B 4-1/2" x 6-1/2" border pieces, (2) medium C/D sashing strips and (1) fabric B 8-1/2" x 6-1/2" border piece, as shown. Check the orientation of the triangle star points. Sew the pieces together to complete a top/bottom border. Make (2) top/bottom borders.

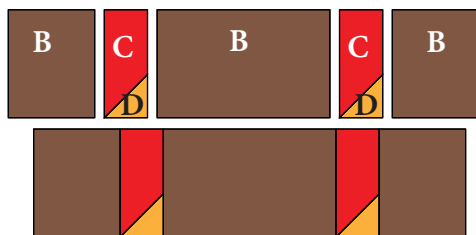

Make 2

5. Referring to the Table Runner Assembly Diagram, sew the top/bottom borders to the table runner center.

## Finishing the Table Runner

Layer the backing fabric, batting and table runner top. Baste the layers together. Hand or machine quilt as desired. Bind to finish the table runner.

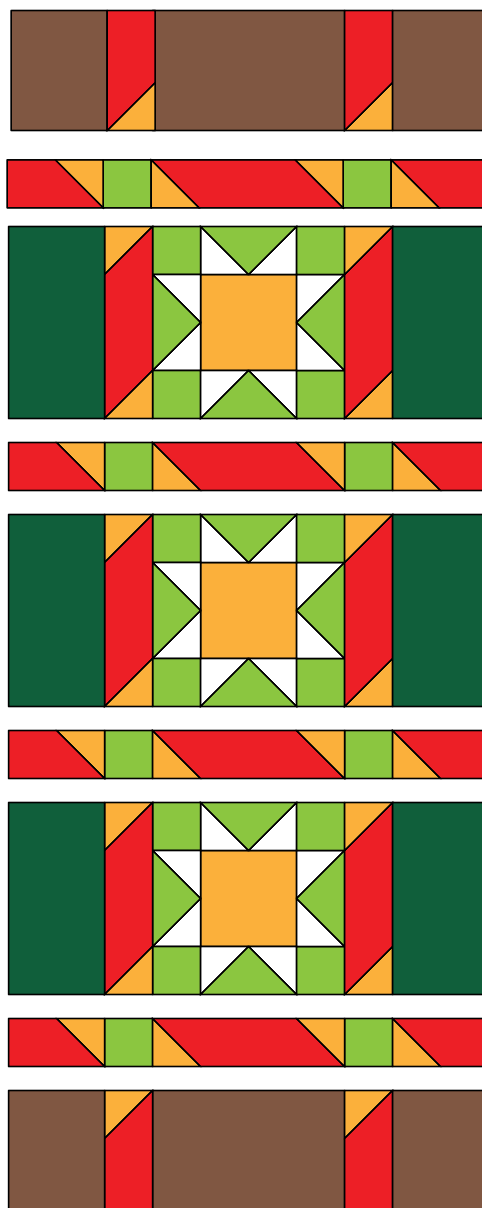

Table Runner Assembly Diagram

*from Quilt Sashings & Settings The basics & beyond  
by Jean Ann Wright*

**Excerpted for the You Choose Quilt-Along  
on QuiltBooksAndBeyond.com**