

Winter Table Runner

The center star blocks are emphasized by the subtle stars in the sashings. A triangle added to each end of a sashing strip creates the sashing stars.



Table Runner designed and made by Jean Ann Wright.

Materials

Finished size approximately 20" x 40"

Star blocks: 8" x 8"

wof indicates width of fabric

Note: Sew all blocks with a scant 1/4" seam and press all seams as you sew.

- Fabric A—1/3 yard holly print (borders)
- Fabric B—1/4 yard tree border print (borders)
- Fabric C—1/2 yard red print (sashings)
- Fabric D—1/2 yard gold print (Star blocks, sashings)
- Fabric E—1/3 yard lime green (Star blocks, sashing squares)
- Fabric F—1/4 yard white mini-print (Star blocks)
- Fabric G—1/3 yard allover tree print (binding)
- Backing—1-1/2 yards
- Thread for machine quilting
- Craft size batting

Note: Sulky® 40 wt Rayon #1051 Christmas green thread and Quilter's Dream® Green batting were used in this project.

Cutting Instructions

Fabric A, cut:

- (1) 8-1/2" x wof strip, from this strip cut:
 - (6) 4-1/2" x 8-1/2" side border pieces.

Fabric B, fussy cut:

- (1) 6-1/2" x wof strip, from this strip cut:
 - (2) 8-1/2" x 6-1/2" top/bottom border pieces.
 - (4) 4-1/2" x 6-1/2" top/bottom border pieces.

Fabric C, cut:

- (5) 2-1/2" x wof strips, from these strips cut:
 - (10) 2-1/2" x 8-1/2" sashing strips,
 - (8) 2-1/2" x 4-1/2" sashing strips and
 - (4) 2-1/2" x 6-1/2" sashing strips.

Fabric D, cut:

- (2) 2-1/2" x wof strips, from these strips cut:
 - (32) 2-1/2" squares.
- (1) 4-1/2" x wof strip, from this strip cut:
 - (3) 4-1/2" squares.

Fabric E, cut:

- (2) 2-1/2" x wof strips, from these strips cut:
 - (20) 2-1/2" squares.

- Cut (2) 2-1/2" x wof strips, from these strips cut:
 - (12) 2-1/2" x 4-1/2" rectangles.

Fabric F, cut:

- (2) 2-1/2" x wof strips, from these strips cut:
(24) 2-1/2" squares.

Fabric G, cut:

- (4) 2-1/4" x wof strips, sew together end-to-end for binding.

- 6. Lay out (2) Flying Geese units and a block center. Sew the units together to make a Star block. Make (3) Star blocks.

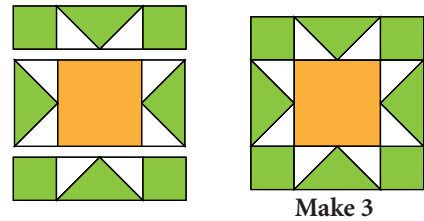

Star Block Assembly

- 1. Lay a fabric F 2-1/2" square on one side of a fabric E 2-1/2" x 4-1/2" rectangle, right sides together. Sew a diagonal line across the 2-1/2" square and through the fabric layers.



- 2. Trim 1/4" away from the sewn line and press the seam allowance toward the triangle.



- 3. Lay a fabric F 2-1/2" square on the opposite side of the fabric E 2-1/2" x 4-1/2" rectangle. Sew, trim and press as before to complete a Flying Geese unit. Make (12) Flying Geese units.

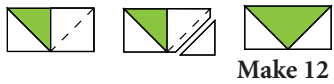

- 4. Sew a Flying Geese unit to opposite sides of a fabric D 4-1/2" square to make a block center. Make (3) block centers.

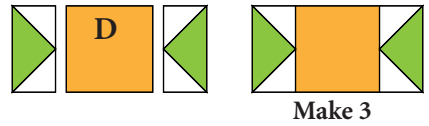

- 5. Sew a fabric E 2-1/2" square to opposite sides of the remaining Flying Geese units.



Sashing Assembly

- 1. Lay a fabric D 2-1/2" square on each end of a fabric C 2-1/2" x 8-1/2" sashing strip, right sides together. Sew in a diagonal line across the 2-1/2" square and through the fabric layers as shown. Make sure both seams are going in the same direction.



- 2. Trim 1/4" away from the sewn line and press seams toward the triangles to make a long C/D sashing strip. Make (10) long C/D sashing strips.



- 3. Lay a fabric D 2-1/2" square on the right end of a fabric C 2-1/2" x 4-1/2" sashing strip, right sides together. Sew a diagonal line in the same direction as the long C/D sashing strips. Make (8) short C/D sashing strips. Repeat with the fabric C 2-1/2" x 6-1/2" sashing strips and the fabric D 2-1/2" squares to make (4) medium C/D sashing strips.



Sashing Row Assembly

- Lay out (2) short C/D sashing strips, (2) fabric E 2-1/2" squares and (1) long C/D sashing strip, as shown. Check the orientation of the triangle star points. Sew the pieces together to complete a sashing row. Make (4) sashing rows.

